

**MACHINE DIMENSIONS**  
Model C-305

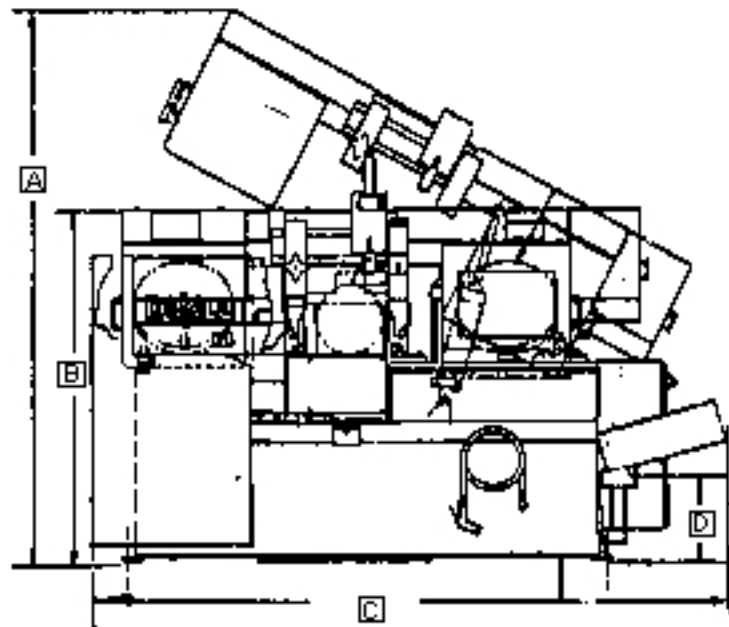

- A** 78-1/2 in. (1,994 mm)
  - B** 50-1/2 in. (1,283 mm)
  - C** 100 in. (2,540 mm)
  - D** 15 in. (381 mm)
  - E** Material pass line 30-1/2 in. (775 mm)
  - F** 74-1/2 in. (1,900 mm)
- Net Weight: 4,200 lbs. (1,905 kg)

**F** Front to back dimension